

## LIMBACH *L 275 E*

**Two cylinder, horizontally opposed, air cooled, two cycle engine, with solid state magneto or battery ignition, mixture lubrication. Suitable for pusher and tractor installations.**

Performance	15 kW (20 HP) at 7200 rpm	Starter	without
Bore	66 mm / 2.60 inch	Generator	without
Stroke	40 mm / 1.57 inch	Dry weight approx.	7.2 kg with magneto ignition
Displacement	274 cm <sup>3</sup> / 16.72 cub. inches	Fuel	AVGAS 100LL or 90 RON mixed with a suitable oil to the ratio of 1:25 or 1:50 (with synthetic oil)
Crankcase	Aluminum casting	Optional Equipment:	Cylinders with additional heat sinks (+ 0.6 kg)
Crankshaft	Drop forged, one piece utilizing 2 split connecting rods with needle bearings		Shielded ignition system
Pistons	Cam ground, casted aluminum alloy		Long and short crankshafts
Cylinders	Casted aluminum alloy, with nicasil coated barrel		Exhaust stacks
Ignition system	Solid state magneto ignition		Starter 12 V, 0.3 kW
Firing Order	Both cylinders simultaneously		Generator 28 V, 1200 W
Carburators	2 diaphragm all position carburators, without choke		

**Limbach Flugmotoren GmbH & Co.KG** **Kotthausener Straße 5**  
**D-53639 Königswinter-Sassenberg**  
**Tel. ++49-2244/9201-0**  
**Fax ++49-2244/9201-30**  
**E-Mail: sales@limflug.de**  
**www.limflug.de**

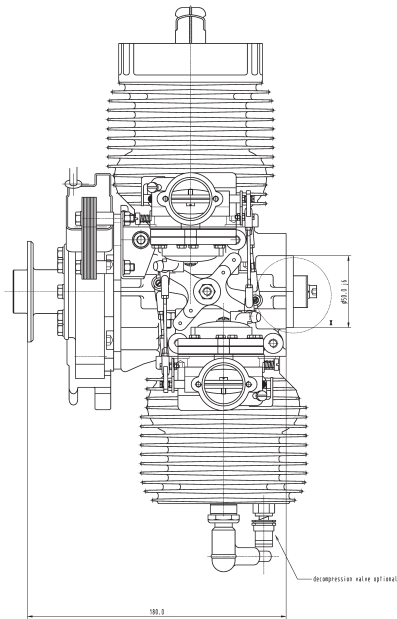
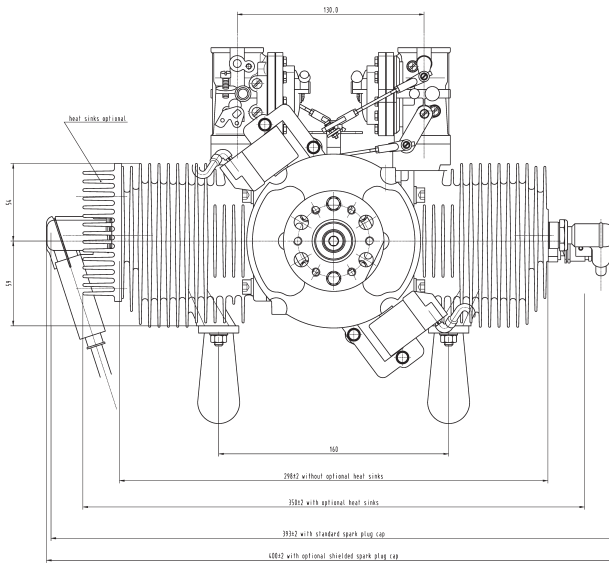
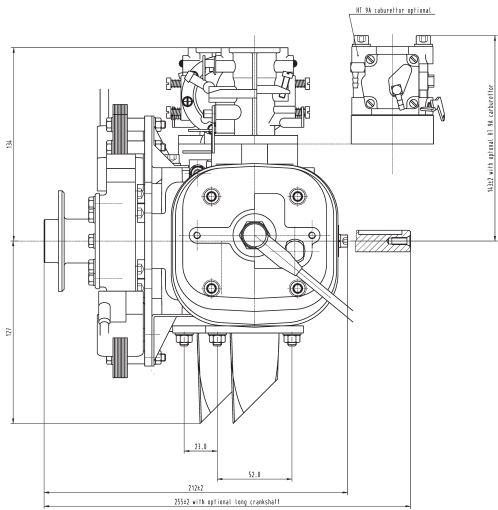

**detail X**

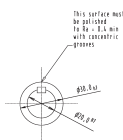
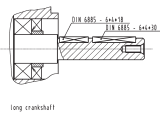
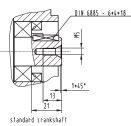

Hub dimensions for aux. pto  
specify 10 mm dia. hole  
when using hub or aux. pto

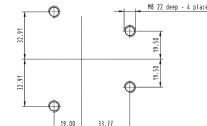
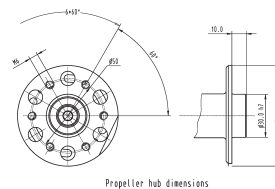
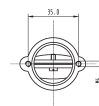

Bolt pattern for engine mount  
use high strength 1200 Nmm bolts

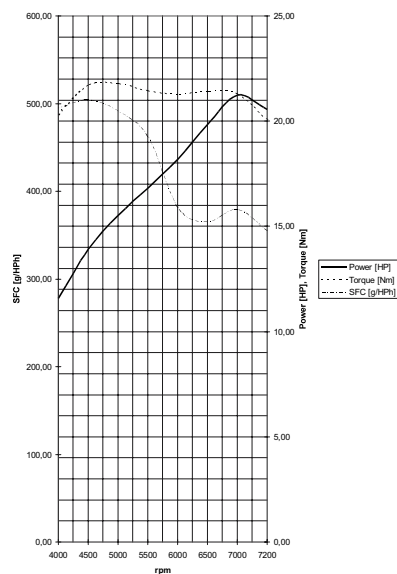
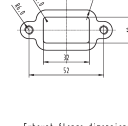

**Limbach Flugmotoren GmbH & Co.KG**  
**Kotthausener Straße 5**  
**D-53639 Königswinter-Sassenberg**  
**Tel. ++49-2244/9201-0**  
**Fax ++49-2244/9201-30**  
**E-Mail: sales@limflug.de**  
**www.limflug.de**